



pathTrack reliably tracks children with suspected hearing disorders for your quality controlled screening.

pathTrack simplifies the daily work within your screening program. The modular software platform increases efficiency and optimises workflows. It provides open interfaces to a variety of screening devices and 3rd party applications for automated data collection, follow-up and statistic purposes. pathTrack helps you to increase program quality and program acceptance and it saves time and money.

Essential for screening programs is the ability to track children who have not passed a hearing test.

Tracking allows best care, service and support in case of suspected hearing disorders.

But: Tracking is connected to the handling of a large amounts of data, secure storage of patient files, easy access for partners and a high degree of process and follow-up automation.

The solution: pathTrack. Our modular software platform helps you to introduce quality control and quality measures in your screening program. It gives all partners quick, reliable and secure access to data through central and unified data storage. It reduces operational and IT costs and builds a foundation for further enhancements, e.g. tracking programs in other health sectors. pathTrack can be tailored dependent on your needs and already established structures. Due to the modular design, pathTrack is highly flexible in data security and workflow management, for your regional, over-regional or even nationwide screening program.

pathTrack is a market proven tool-set that increases the acceptance of screening programs as it simplifies access to information and strengthens networking between partners.

- Central data storage in unified format on one single server
- Supports data acquisition and standardization from multiple sources: Easily connects to heterogeneous screening technologies: Handhelds, PC based devices, 3rd party applications
- Rule based workflow and follow-up management, statistics and backup – on one single platform
- Supplies a unique and secure screening ID per patient for one-to-one patient relations
- Internet-based interfaces allow secure and quick data exchange; unions of regions or nations can rely on patients even if they have moved away from the region of responsibility of their initial tracking centre
- Market proven solution, developed in cooperation with Nenaserv Ltd. based on Microsoft Windows technology; easily integrates in existing infrastructures, shares existing resources to spare your budget
- Evaluation, planning, roll-out and maintenance services available from pathConsult

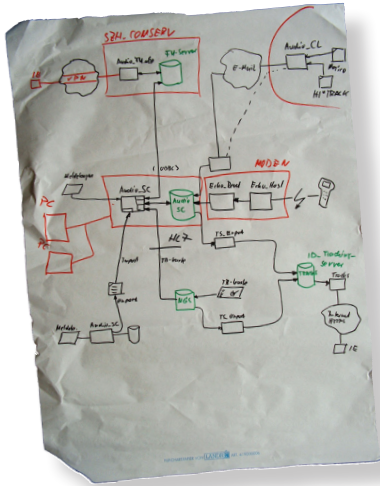

pathTrack – Product Overview

How can I simplify my daily screening work? Sample structure of pathTrack, related to a nation-wide screening program. The set up for a regional solution might consist of the tracking database only.

About PATH medical:

The ability of hearing is one of man's most precious sensations. To know if a newborn can hear is essential for babies' and children's boundless development, perception, and learning.

In many cases hearing impairment can be treated or cured if detected early enough. PATH medical cares about your hearing and therefore provides means to help detecting hearing loss in early stages. PATH medical is dedicated to develop and to use the best technology in order to provide innovative solutions in audiological diagnostics for all age and risk groups - from newborns and preschoolers to grand-parents.

In cooperation with leading universities, PATH medical supports basic research on new strategies and methods in audiology. It is part of PATH medical's mission to analyse and transfer the best results from research to innovations and technical solutions.

The company focuses on the field of NHS tracking, objective and subjective audiological diagnostics including (pre)school hearing screening, adult hearing screening, and consulting services.

PATH medical GmbH
Landsberger Straße 63
82110 Germering
Germany
Tel. +49 89 800 76 502
Fax +49 89 800 76 503
E-Mail info@pathme.de
Web www.pathme.de

Managing Directors:
Dr.-Ing. Hans Oswald
Peter Zoth
Commercial Register:
HRB 167243
AG München
VAT-ID DE 254491320
0701-brochure_eng_rev1

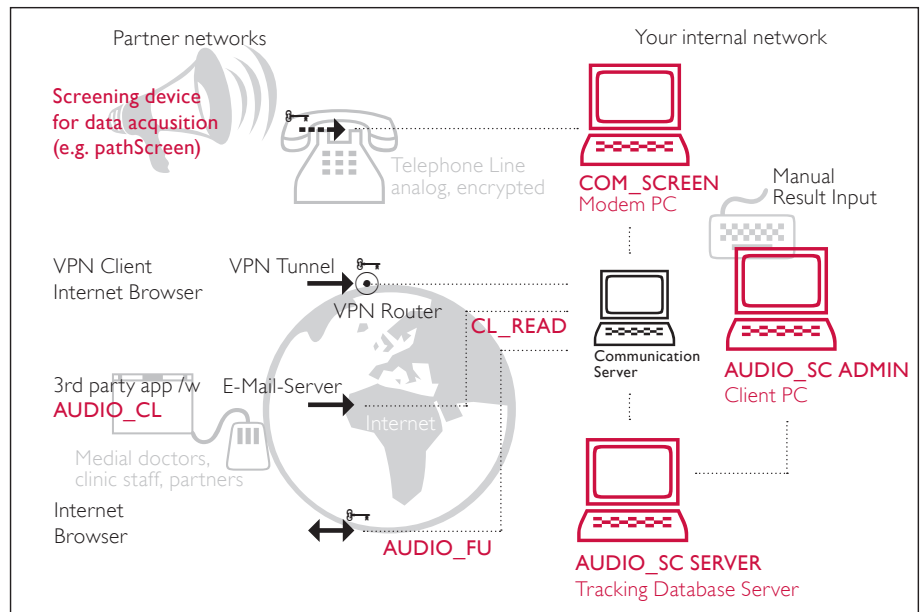

pathTrack – Sample structure of support for a nation-wide screening program Software components and system requirements

| Components | Features | System Requirements |
|--|--|--|
| AUDIO_SC SERVER incl. AUDIO_SC ADMIN | Core application: database server provides interfaces, unification logic, rules engine, statistic and reporting tools; administration via Admin console | Server: Windows 2003 server standard edition and higher, 1 GB RAM, dual processor; hard disc (raid Level 5 suggested), hard disc volume ca. 5 kByte per child, network card Client: Windows (starting from Windows 2000), low standard office PC, network |
| COM_SCREEN | Intelligent modem and translation server; responsible for reception of data from external devices and 3rd party applications; translation and forwarding to AUDIO_SC | Windows (starting from Windows 98), low standard office PC, network |
| AUDIO_CL incl. CL_READ | Extension for PC based screening applications; securely transfers screening data from desktops at partner sites into your infrastructure | Windows 2000 or above, low standard office PC, network, email access |
| AUDIO_FU | Follow-up server for Internet based retrieval and editing of patient data; unique ID grants limited access to authorised persons only; multiple tracking rules and makros for automation | Windows 2003 server standard edition, 1GB RAM, dual processor; Hard disc (raid Level 1 or 5 suggested), hard disc volume ca. 10 kByte per child, 2 x network cards |
| Additionally useful / suggested: Uninterruptible power supply (USV), backup-system, air conditioned server room, noise protection (closed 19"rack), hard/software for secure Internet connectivity (e.g. VPN, SSL) | | |