

QUICK START GUIDE

SENTIERO HANDHELD OAE AND AUDIOMETRY SCREENER (GREEN LABEL)

TURNING ON/OFF, CHARGING THE DEVICE



On/off
button on
right side



Power
supply
connector

START MENU

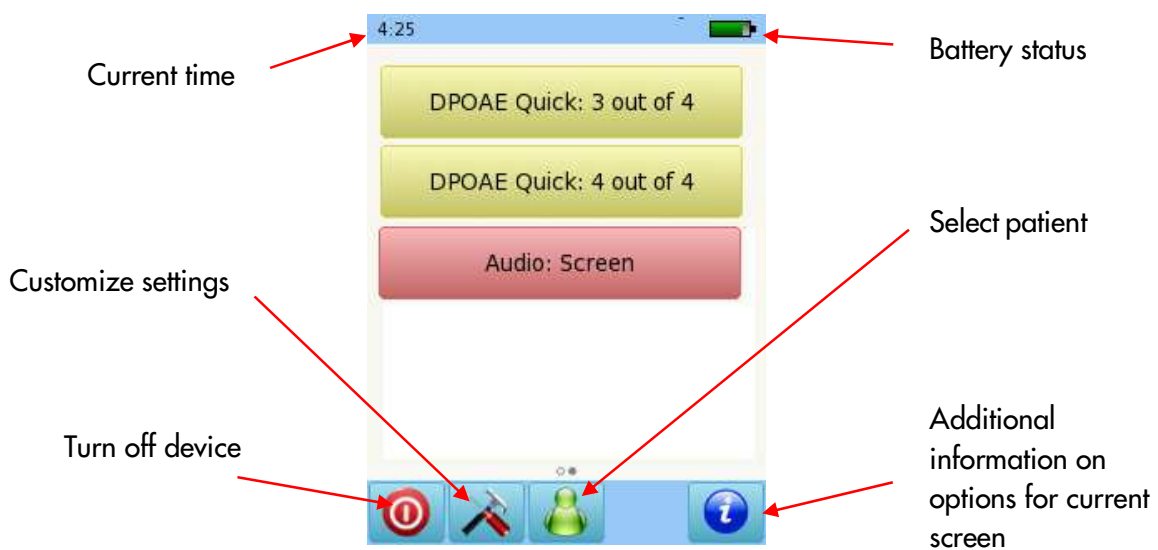

TESTING

AUDIOMETRY

Connect the headphones to the blue connector. Select the Audiometry: Screening button from the start menu. Select the ear on which you want to start the test.

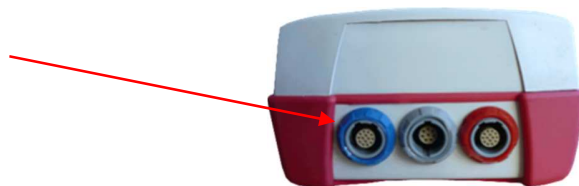

QUICK START GUIDE

SENTIERO HANDHELD OAE AND AUDIOMETRY SCREENER (GREEN LABEL)

AUDIOMETRY TEST SCREEN

Stimulus on indicator

Select the stimulus levels

Select the frequency

Press to present the stimulus

Stop test

Additional information about options for current screen

Select the ear to test

Select the type of stimulus: pure tone pulsed tone or warble FM

As you present the stimulus, the current level will be displayed on the corresponding (yellow) square. Once the hearing status for a frequency has been identified, move on to the next frequency.

Tapping twice on a square will display NR (no response).

Tap three times to get back to a blank square.

Once all frequencies have been tested for one ear, you can test the other ear.

QUICK START GUIDE

SENTIERO HANDHELD OAE AND AUDIOMETRY SCREENER (GREEN LABEL)

When the test is finished, press the Stop button. You can add the patient's personal data, and save on the device, print to a label (a label printer is required) or print to a pdf file or full page report on PC.

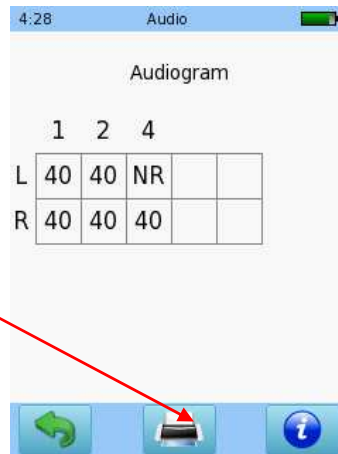

DISTORTION PRODUCT OTOACUSTIC EMISSIONS (DPOAE) SCREENING

Connect the probe to the red connector. Select either the Screening or the Standard button from the start menu.



Select the appropriate ear tip size and place it on the probe tip. Insert the probe in the ear making sure that the ear tip fits tightly into the ear canal.

Select the test ear by pressing either the Right or Left button. Select balloon mode to show balloons when the test is finished.

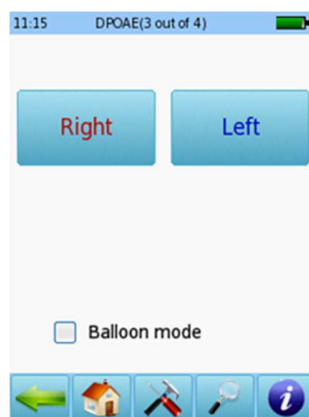

QUICK START GUIDE

SENTIERO HANDHELD OAE AND AUDIOMETRY SCREENER (GREEN LABEL)

A calibration will be performed prior to measurement. A green light indicates successful calibration (see below left). After successful ear probe calibration, the test will start automatically.

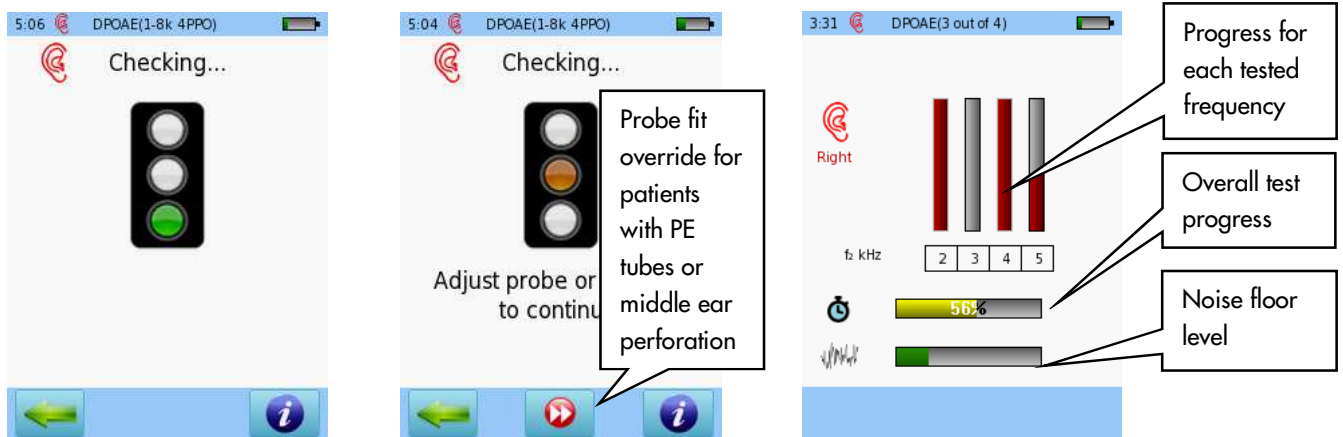

DPOAE TEST RESULTS

RESULTS VIEW (Simple)

Please note that the initial result screen depends on the module settings in "DPOAE Preferences"

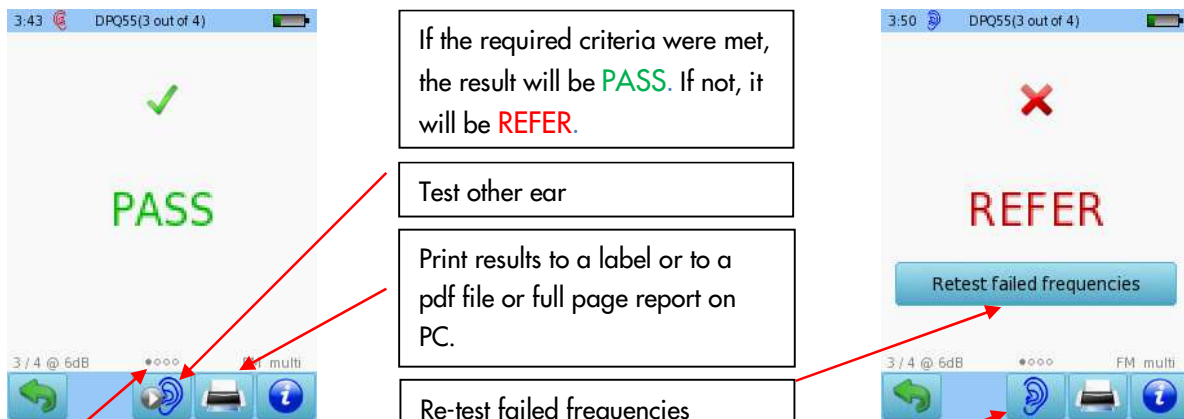

Note: These circles indicate that other screens are available to view. Swipe your finger right or left to get other views.

QUICK START GUIDE

SENTIERO HANDHELD OAE AND AUDIOMETRY SCREENER (GREEN LABEL)

DETAILED RESULTS VIEW

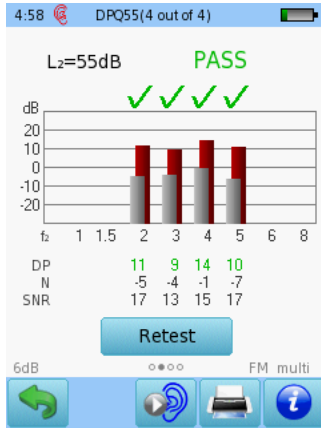

Red or blue bars indicate response, grey bars indicate noise

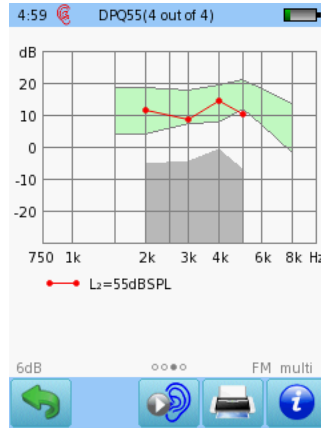

Outcome for each test sorted by f₂ and L₂

4:59 DPQ55(4 out of 4)

L ₂	f ₂	DPOAE	N	SNR
55	2000	11.4	-5.2	16.7
55	3000	8.6	-4.5	13.0
55	4000	14.2	-0.7	14.9
55	5000	10.3	-6.7	16.9

6dB FM multi

Numeric values shown in table format

QUICK START GUIDE

SENTIERO HANDHELD OAE AND AUDIOMETRY SCREENER (GREEN LABEL)

Quick Guide Information

Release date: 2017-01-11
Revision: 02
Valid from: Firmware Rev. 2.1, Mira PC Software Rev. 1.6.4
Applies to: Model: SOH100098, web description SOH01

All mentioned items, products, brands and trademarks are registered or owned by the mentioned companies.

All information, illustrations, and specifications provided within this manual are based on the latest product information available at the time of publication. PATH medical reserves the right to make changes at any time without notice.

Please note that not all products displayed on our webpage or advertising materials are available in all territories. Please contact your local distributor or PATH medical for further information.

The latest revision of the Quick Start Guide is available online at www.pathme.de/download.

Errors and omissions excepted.

Copyright Notice

No part of this manual may be reproduced, translated, stored, or transmitted, in any form or by any means, electronic, mechanical, photocopying, recording, or otherwise, without the prior written consent of PATH medical GmbH.

Copyright © 2016 PATH medical GmbH

PATH medical GmbH
Landsberger Straße 65
82110 Germering
Germany

Tel.: +49 89 800 76 502 Fax: +49 89 800 76 503 Internet: www.pathme.de

CE
0124